

The Astera

INTERIORS BY ASTON MARTIN



DARGLOBAL

Joint Development Partner



ARVEES

THE MOST DESIRABLE LUXURY RESIDENCES IN THE WORLD

WORLD-CLASS AMENITIES DECK

- 1 Indoor Cinema
- 2 Fitness Centre
- 3 Multipurpose Hall
- 4 Kids Play Area
- 5 Yoga Lawn
- 6 Spa
- 7 Infinity Pool
- 8 Pool bar





EVERY SENSE
EMPOWERED



FLOOR PLANS

3 BEDROOMS VILLA TYPE A

The Astera

INTERIORS BY ASTON MARTIN

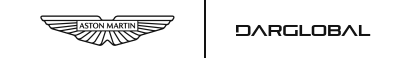

SEA & ISLAND VIEW

BEACH FRONT VIEW

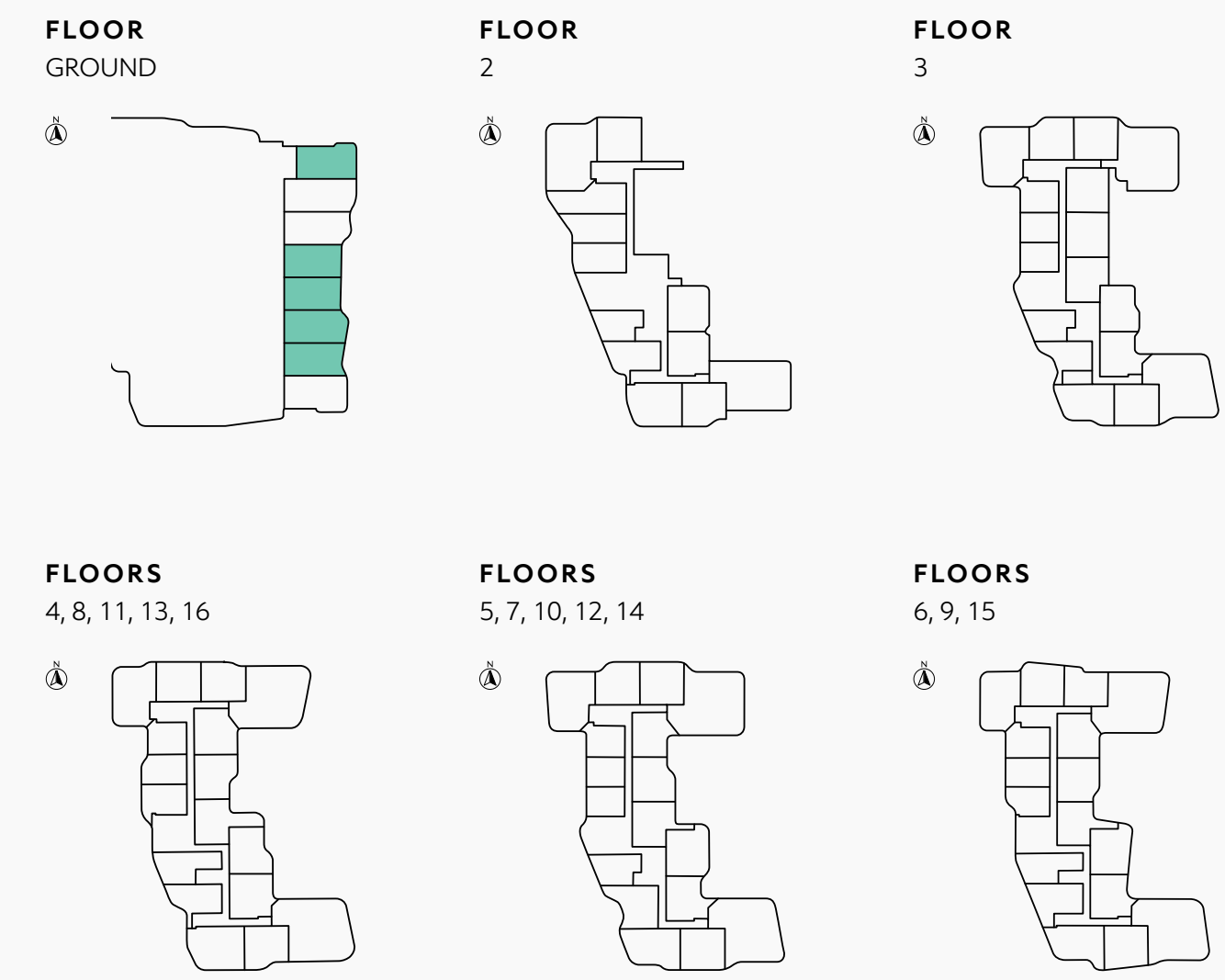

RESIDENCE	SQM	SQFT
Internal Area	195	2,098
Balcony Area	33 - 44	360 - 476
Total Built up Area	228 - 239	2,456 - 2,573

Disclaimer: All pictures, plans, layouts, information, data and details included in this brochure are indicative only and may change at any time up to the final 'as built' status in accordance with final designs of the project, regulatory approvals and planning permissions. All accessories and interior finishes such as wallpaper, chandeliers, furniture, electronics, white goods, curtains, hard and soft landscaping, pavements, features, gym, and other elements displayed in the brochure, or between the plot boundary, are not part of the unit and are shown for illustrative purposes only.



LOWER LEVEL

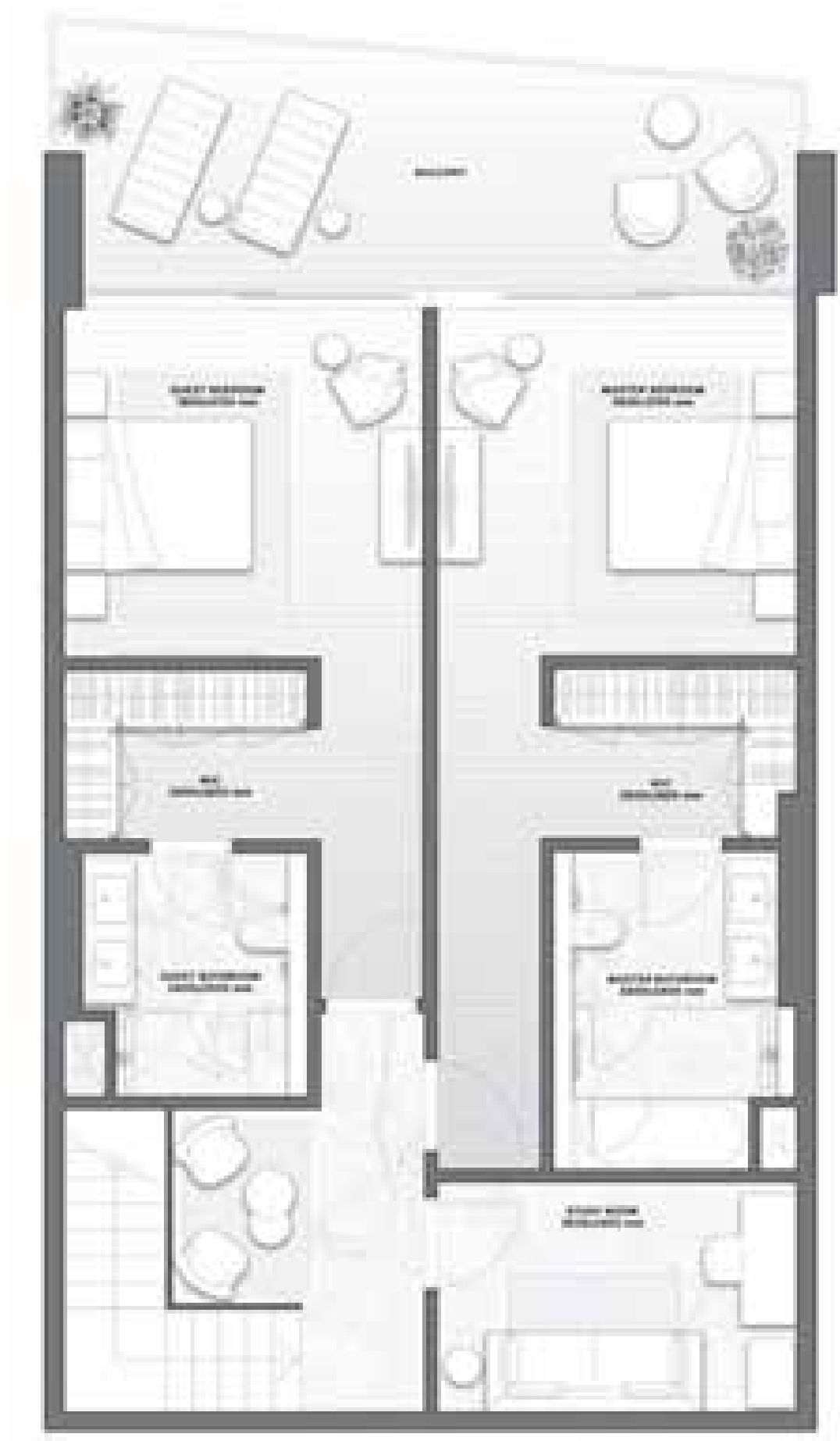

UPPER LEVEL

3 BEDROOMS VILLA TYPE B

The Astera INTERIORS BY ASTON MARTIN

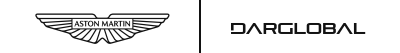

SEA & ISLAND VIEW

FLOOR
GROUND

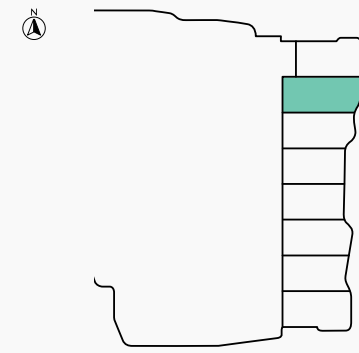

FLOOR
2

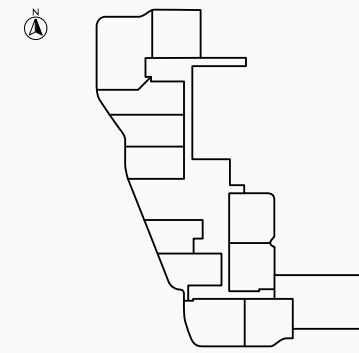

FLOOR
3

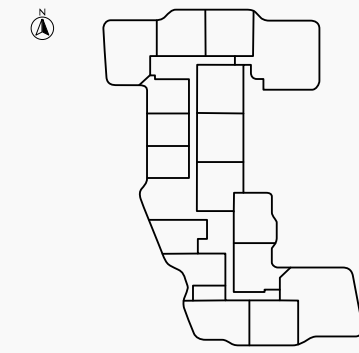

FLOORS
4, 8, 11, 13, 16

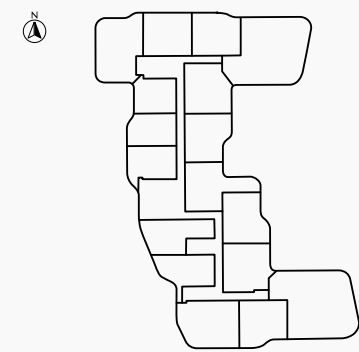

FLOORS
5, 7, 10, 12, 14

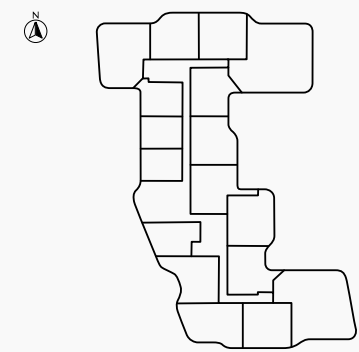

FLOORS
6, 9, 15

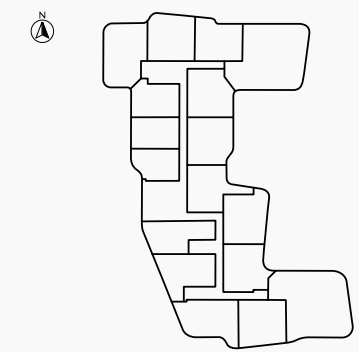

BEACH FRONT VIEW

RESIDENCE	SQM	SQFT
Internal Area	226	2,431
Baclony Area	41	445
Total Built up Area	267	2,876

Disclaimer: All pictures, plans, layouts, information, data and details included in this brochure are indicative only and may change at any time up to the final 'as built' status in accordance with final designs of the project, regulatory approvals and planning permissions. All accessories and interior finishes such as wallpaper, chandeliers, furniture, electronics, white goods, curtains, hard and soft landscaping, pavements, features, gym, and other elements displayed in the brochure, or between the plot boundary, are not part of the unit and are shown for illustrative purposes only.

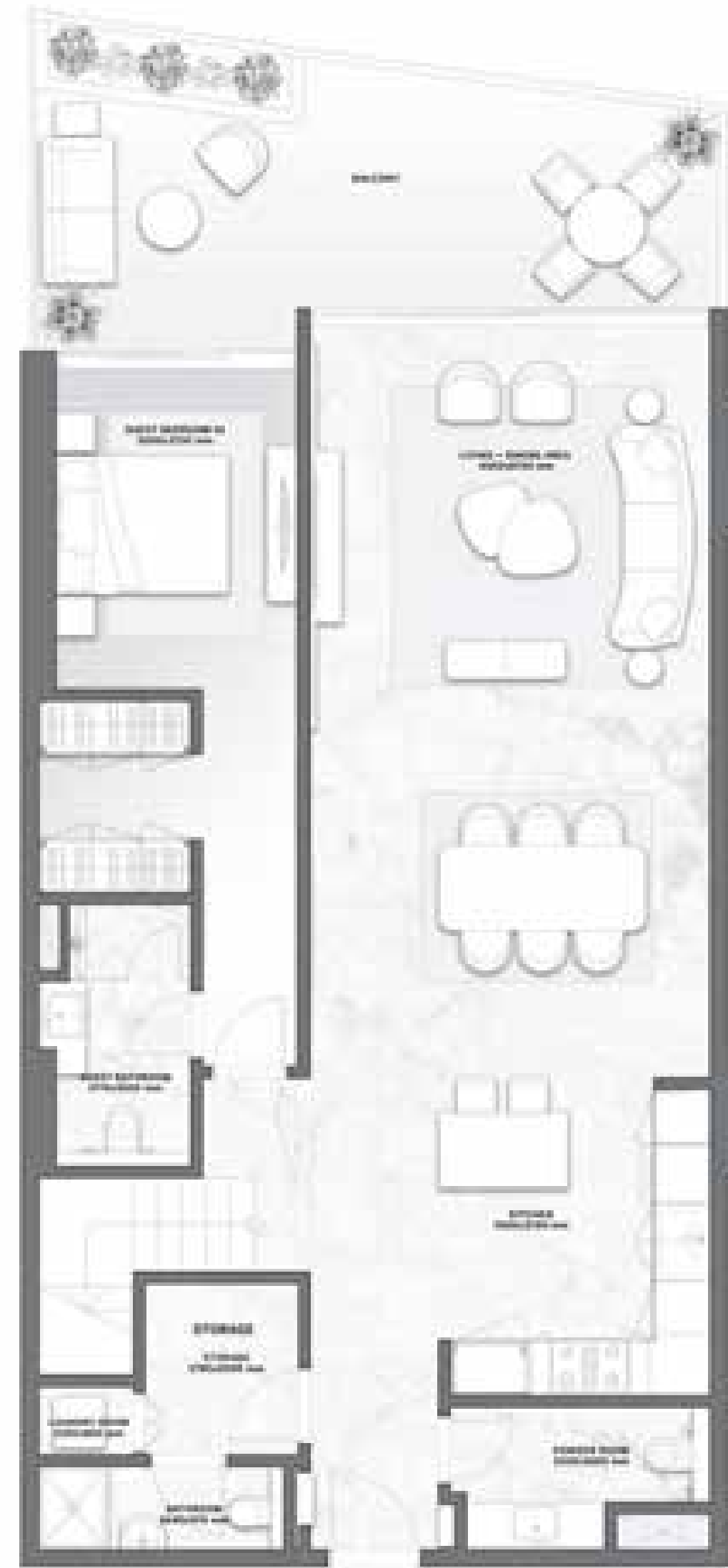

LOWER LEVEL



UPPER LEVEL

3 BEDROOMS VILLA TYPE C

The Astera

INTERIORS BY ASTON MARTIN

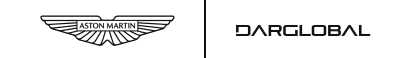

SEA & ISLAND VIEW

BEACH FRONT VIEW

FLOOR GROUND

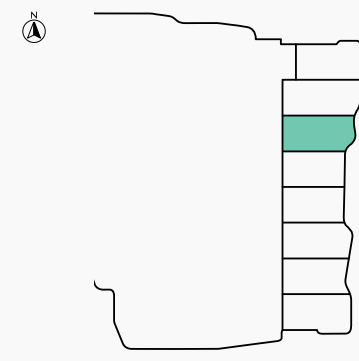

FLOOR 2

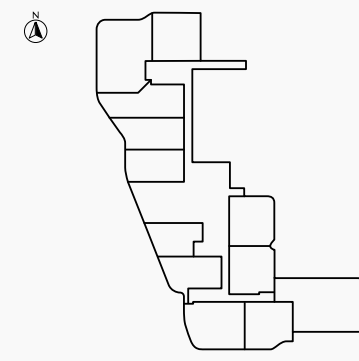

FLOOR 3

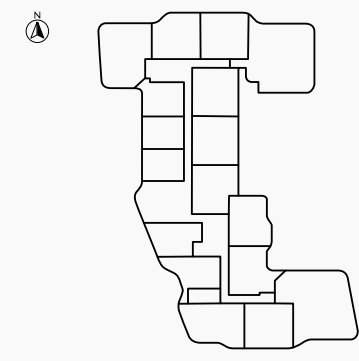

FLOORS 4, 8, 11, 13, 16

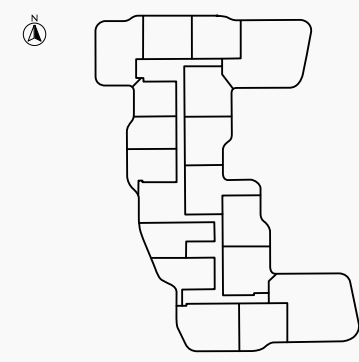

FLOORS 5, 7, 10, 12, 14

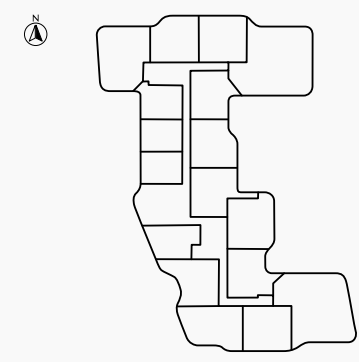

FLOORS 6, 9, 15

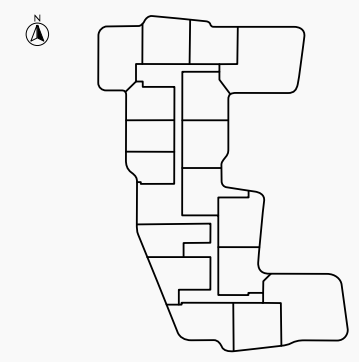

RESIDENCE	SQM	SQFT
Internal Area	211	2,269
Baclony Area	41	440
Total Built up Area	252	2,709

Disclaimer: All pictures, plans, layouts, information, data and details included in this brochure are indicative only and may change at any time up to the final 'as built' status in accordance with final designs of the project, regulatory approvals and planning permissions. All accessories and interior finishes such as wallpaper, chandeliers, furniture, electronics, white goods, curtains, hard and soft landscaping, pavements, features, gym, and other elements displayed in the brochure, or between the plot boundary, are not part of the unit and are shown for illustrative purposes only.



LOWER LEVEL

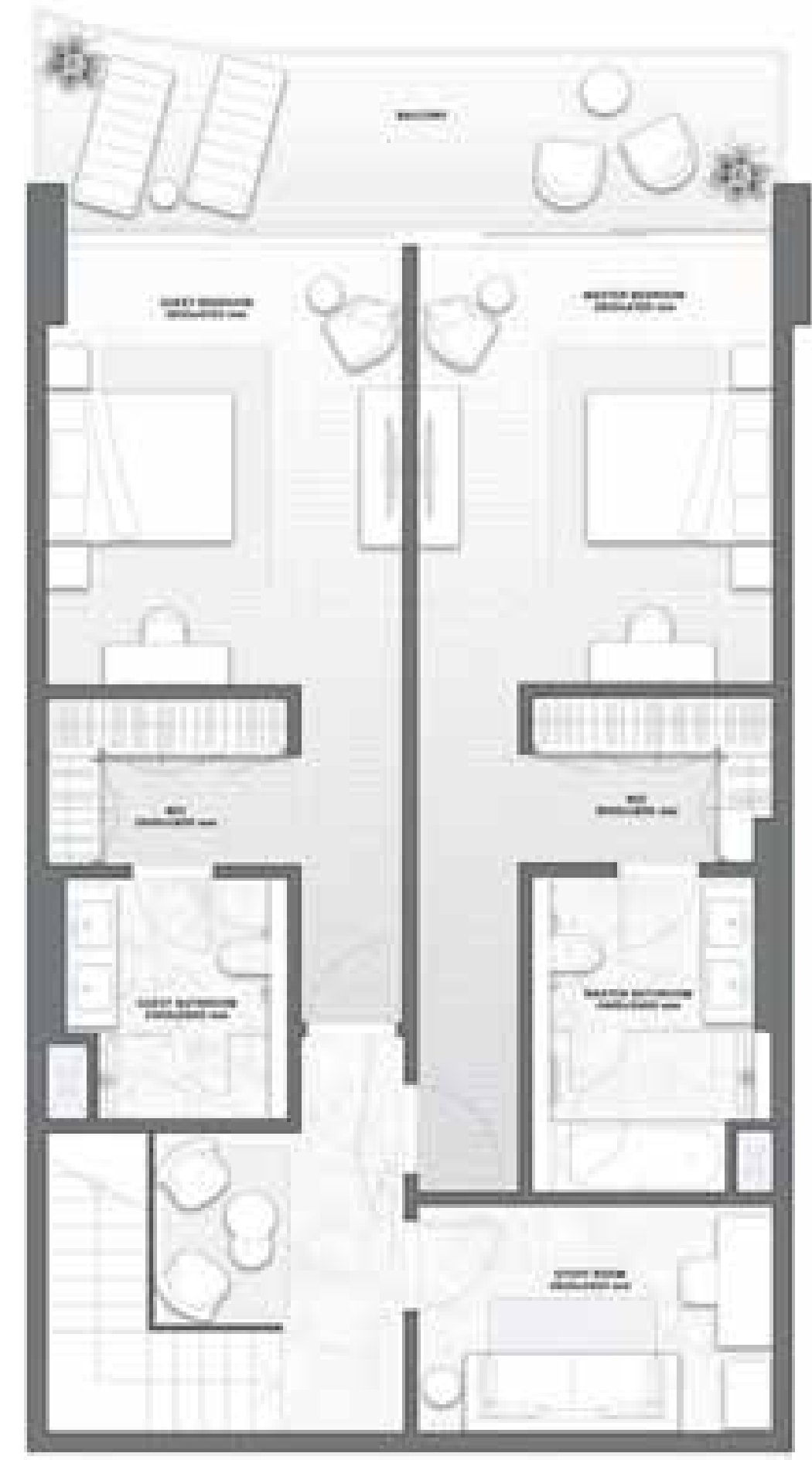

UPPER LEVEL

3 BEDROOMS VILLA TYPE D

The Astera

INTERIORS BY ASTON MARTIN

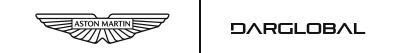

SEA & ISLAND VIEW

FLOOR
GROUND

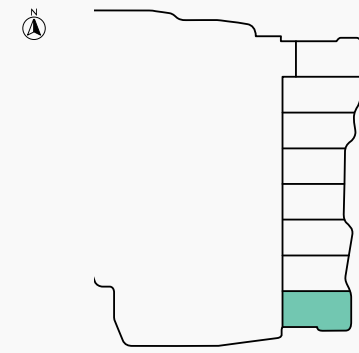

FLOOR
2

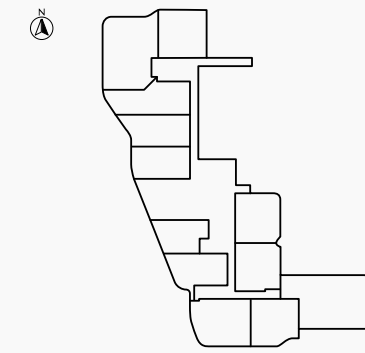

FLOOR
3

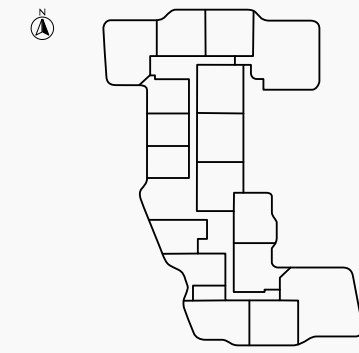

FLOORS
4, 8, 11, 13, 16

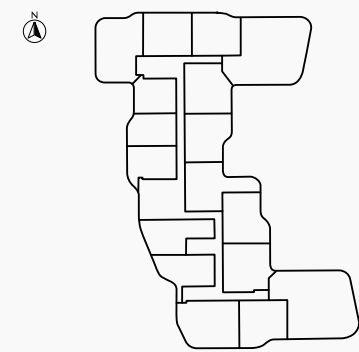

FLOORS
5, 7, 10, 12, 14

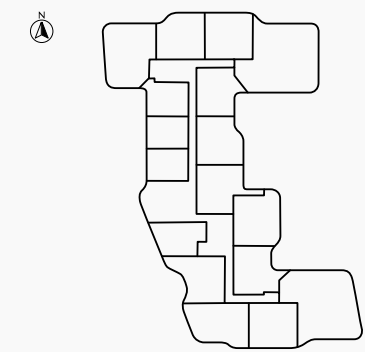

FLOORS
6, 9, 15

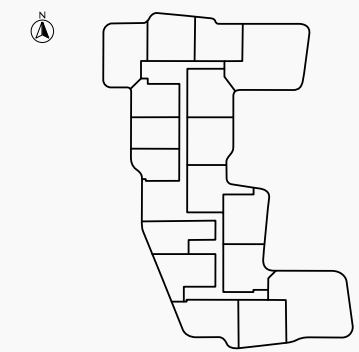

BEACH FRONT VIEW

RESIDENCE	SQM	SQFT
Internal Area	194	2,090
Baclony Area	34	364
Total Built up Area	228	2,455

Disclaimer: All pictures, plans, layouts, information, data and details included in this brochure are indicative only and may change at any time up to the final 'as built' status in accordance with final designs of the project, regulatory approvals and planning permissions. All accessories and interior finishes such as wallpaper, chandeliers, furniture, electronics, white goods, curtains, hard and soft landscaping, pavements, features, gym, and other elements displayed in the brochure, or between the plot boundary, are not part of the unit and are shown for illustrative purposes only.



LOWER LEVEL



UPPER LEVEL

1 BEDROOM TYPE A

The Astera
INTERIORS BY ASTON MARTIN

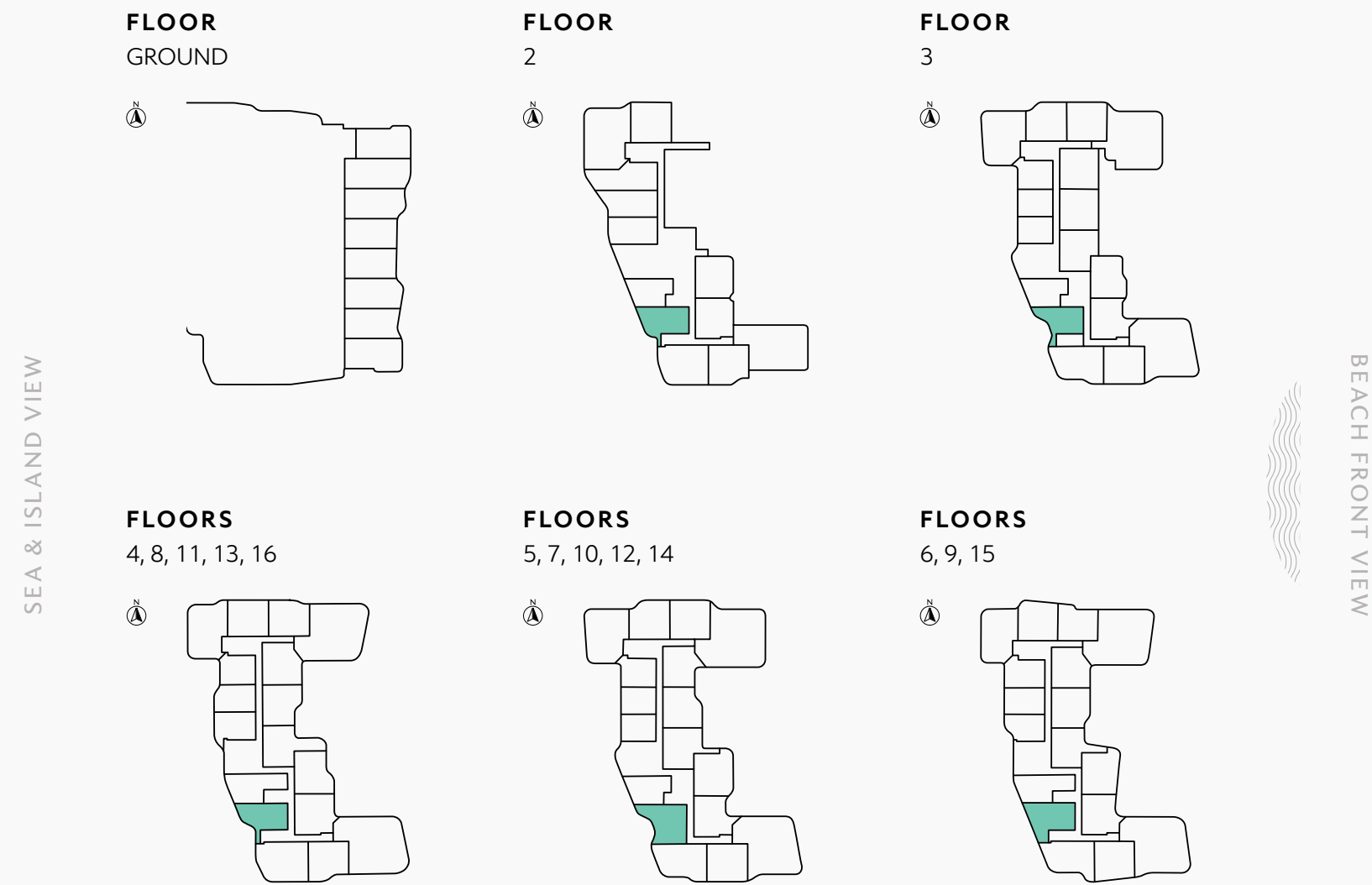
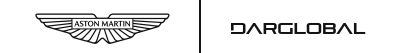

RESIDENCE	SQM	SQFT
Internal Area	48	522
Baclony Area	34 - 52	372 - 564
Total Built up Area	83 - 101	894 - 1,087

Disclaimer: All pictures, plans, layouts, information, data and details included in this brochure are indicative only and may change at any time up to the final 'as built' status in accordance with final designs of the project, regulatory approvals and planning permissions. All accessories and interior finishes such as wallpaper, chandeliers, furniture, electronics, white goods, curtains, hard and soft landscaping, pavements, features, gym, and other elements displayed in the brochure, or between the plot boundary, are not part of the unit and are shown for illustrative purposes only.



1 BEDROOM TYPE B

The Astera
INTERIORS BY ASTON MARTIN

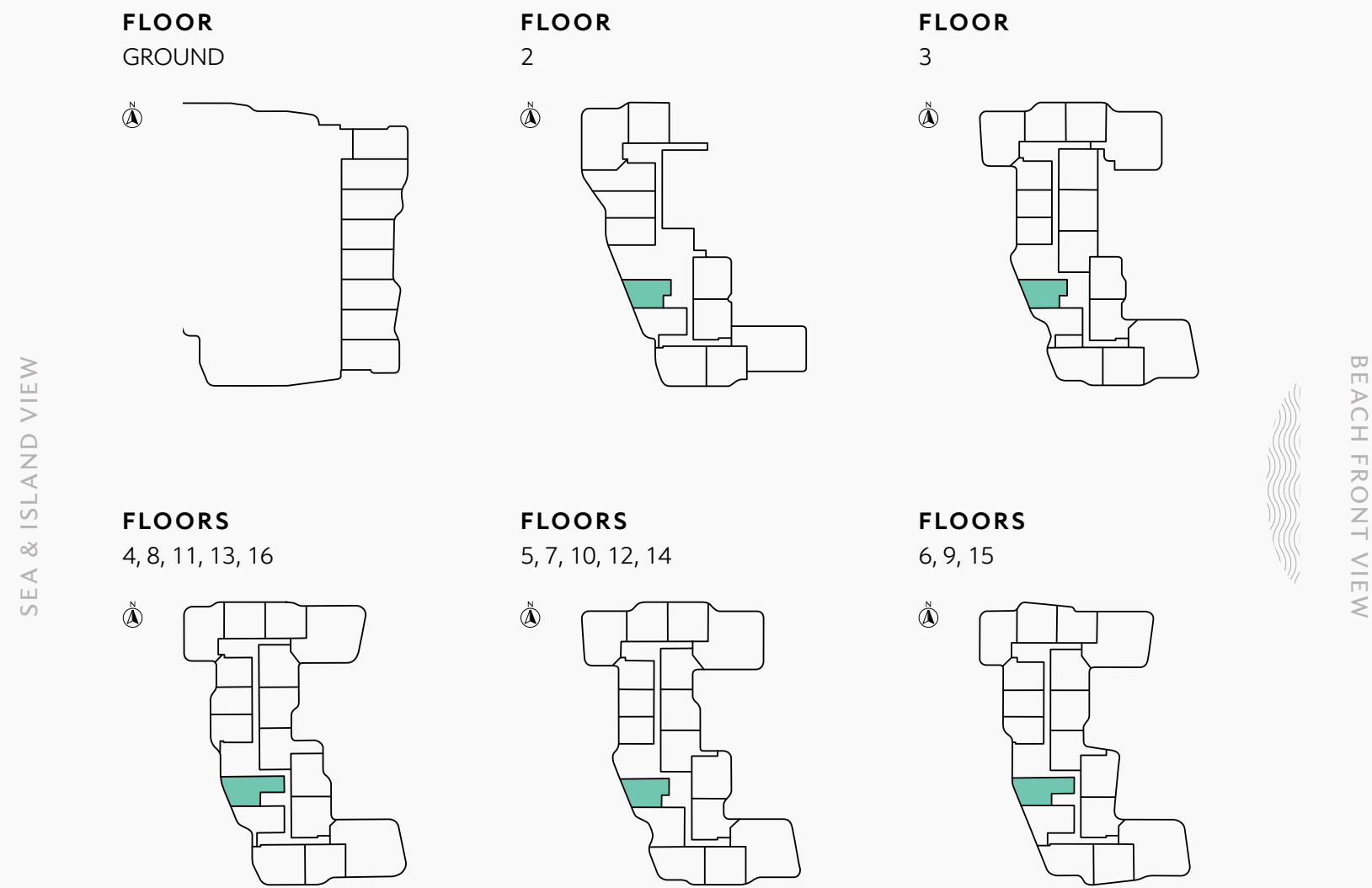

RESIDENCE	SQM	SQFT
Internal Area	58	623
Baclony Area	19 - 20	209 - 214
Total Built up Area	77 - 78	832 - 837

Disclaimer: All pictures, plans, layouts, information, data and details included in this brochure are indicative only and may change at any time up to the final 'as built' status in accordance with final designs of the project, regulatory approvals and planning permissions. All accessories and interior finishes such as wallpaper, chandeliers, furniture, electronics, white goods, curtains, hard and soft landscaping, pavements, features, gym, and other elements displayed in the brochure, or between the plot boundary, are not part of the unit and are shown for illustrative purposes only.



1 BEDROOM TYPE C

The Astera
INTERIORS BY ASTON MARTIN

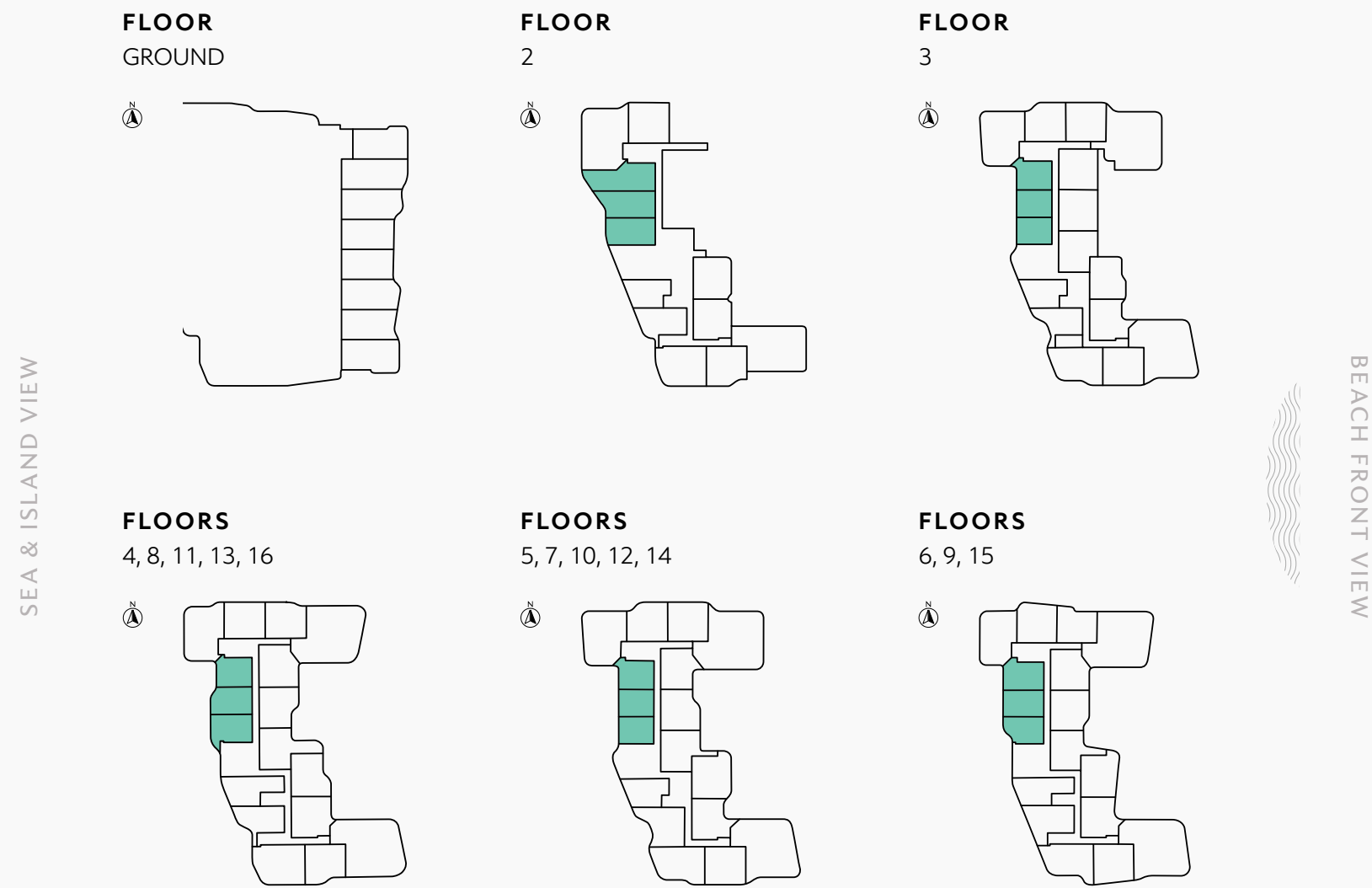
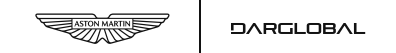

RESIDENCE	SQM	SQFT
Internal Area	52 - 55	562 - 595
Baclony Area	11 - 65	119 - 702
Total Built up Area	63 - 120	682 - 1,297



Disclaimer: All pictures, plans, layouts, information, data and details included in this brochure are indicative only and may change at any time up to the final 'as built' status in accordance with final designs of the project, regulatory approvals and planning permissions. All accessories and interior finishes such as wallpaper, chandeliers, furniture, electronics, white goods, curtains, hard and soft landscaping, pavements, features, gym, and other elements displayed in the brochure, or between the plot boundary, are not part of the unit and are shown for illustrative purposes only.

2 BEDROOMS TYPE A

The Astera
INTERIORS BY ASTON MARTIN

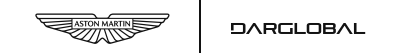

SEA & ISLAND VIEW

FLOOR
GROUND

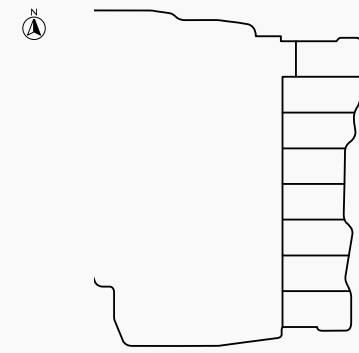

FLOOR
2

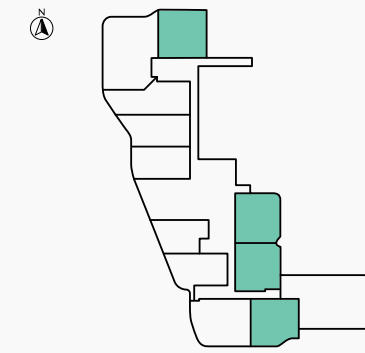

FLOOR
3

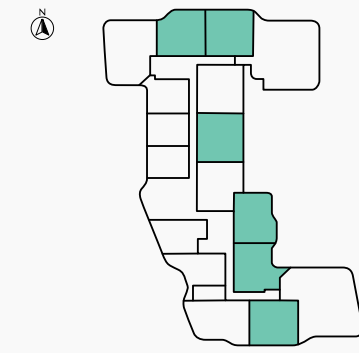

FLOORS
4, 8, 11, 13, 16

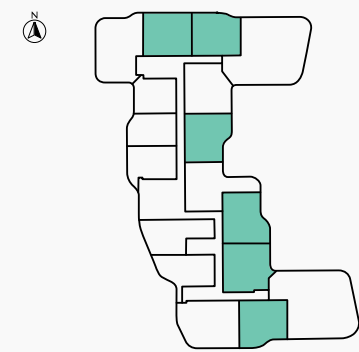

FLOORS
5, 7, 10, 12, 14

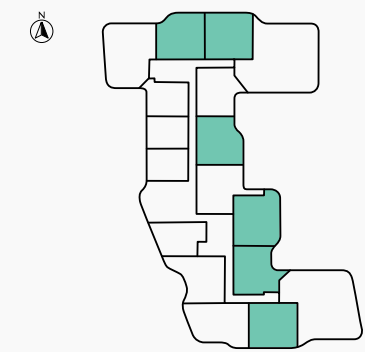

FLOORS
6, 9, 15

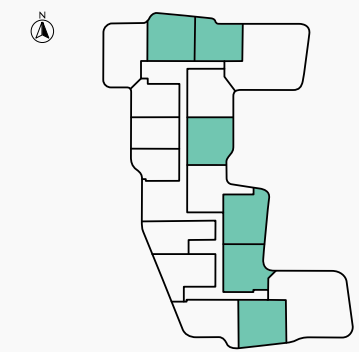

BEACH FRONT VIEW

RESIDENCE	SQM	SQFT
Internal Area	68 - 73	733 - 786
Balcony Area	23 - 43	252 - 467
Total Built up Area	93 - 116	1,002 - 1,252

Disclaimer: All pictures, plans, layouts, information, data and details included in this brochure are indicative only and may change at any time up to the final 'as built' status in accordance with final designs of the project, regulatory approvals and planning permissions. All accessories and interior finishes such as wallpaper, chandeliers, furniture, electronics, white goods, curtains, hard and soft landscaping, pavements, features, gym, and other elements displayed in the brochure, or between the plot boundary, are not part of the unit and are shown for illustrative purposes only.



2 BEDROOMS TYPE B

The Astera
INTERIORS BY ASTON MARTIN

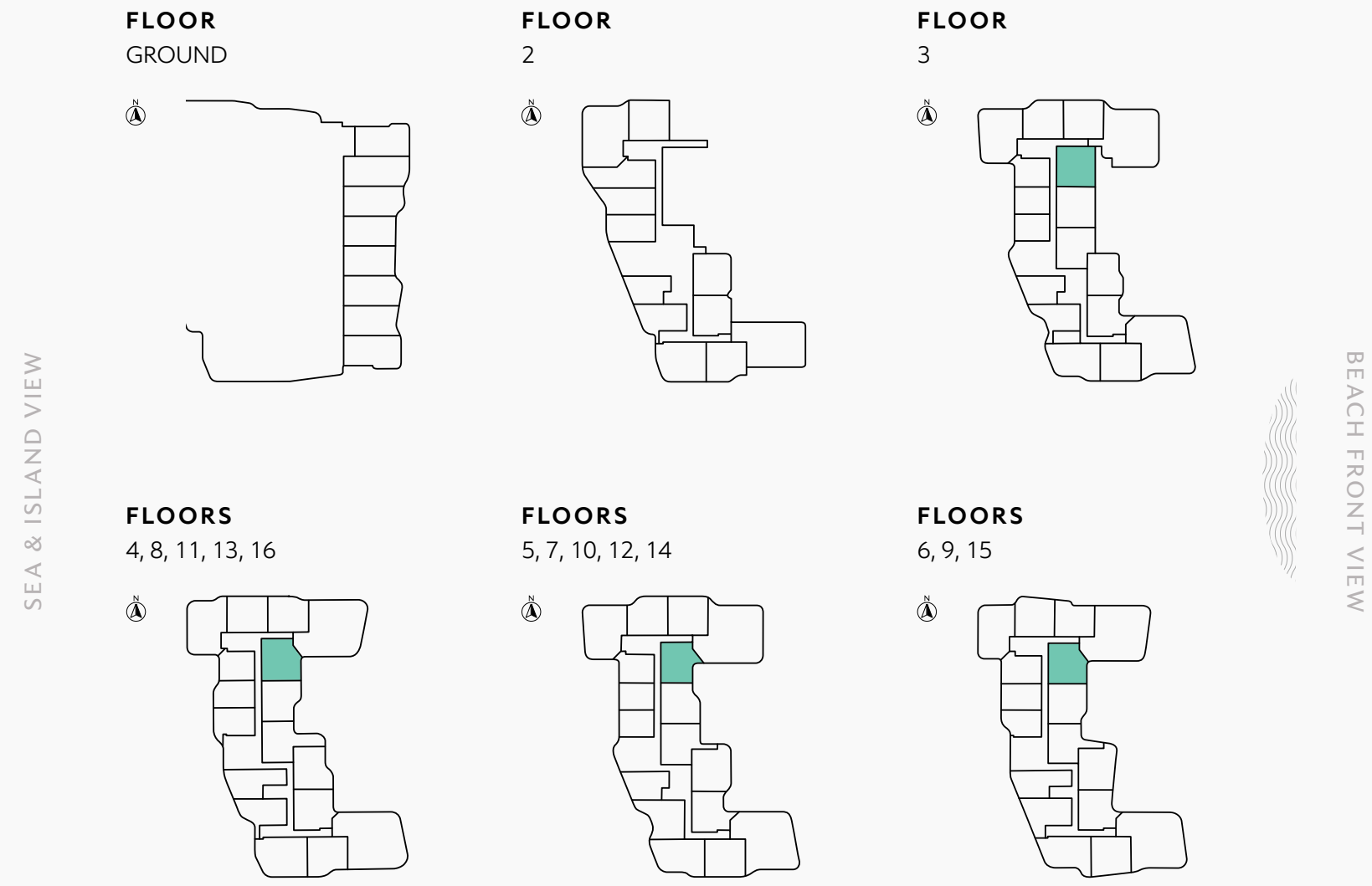
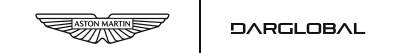

RESIDENCE	SQM	SQFT
Internal Area	68	729
Baclony Area	23 - 34	252 - 369
Total Built up Area	91 - 102	981 - 1,098



Disclaimer: All pictures, plans, layouts, information, data and details included in this brochure are indicative only and may change at any time up to the final 'as built' status in accordance with final designs of the project, regulatory approvals and planning permissions. All accessories and interior finishes such as wallpaper, chandeliers, furniture, electronics, white goods, curtains, hard and soft landscaping, pavements, features, gym, and other elements displayed in the brochure, or between the plot boundary, are not part of the unit and are shown for illustrative purposes only.

2 BEDROOMS TYPE C

The Astera
INTERIORS BY ASTON MARTIN

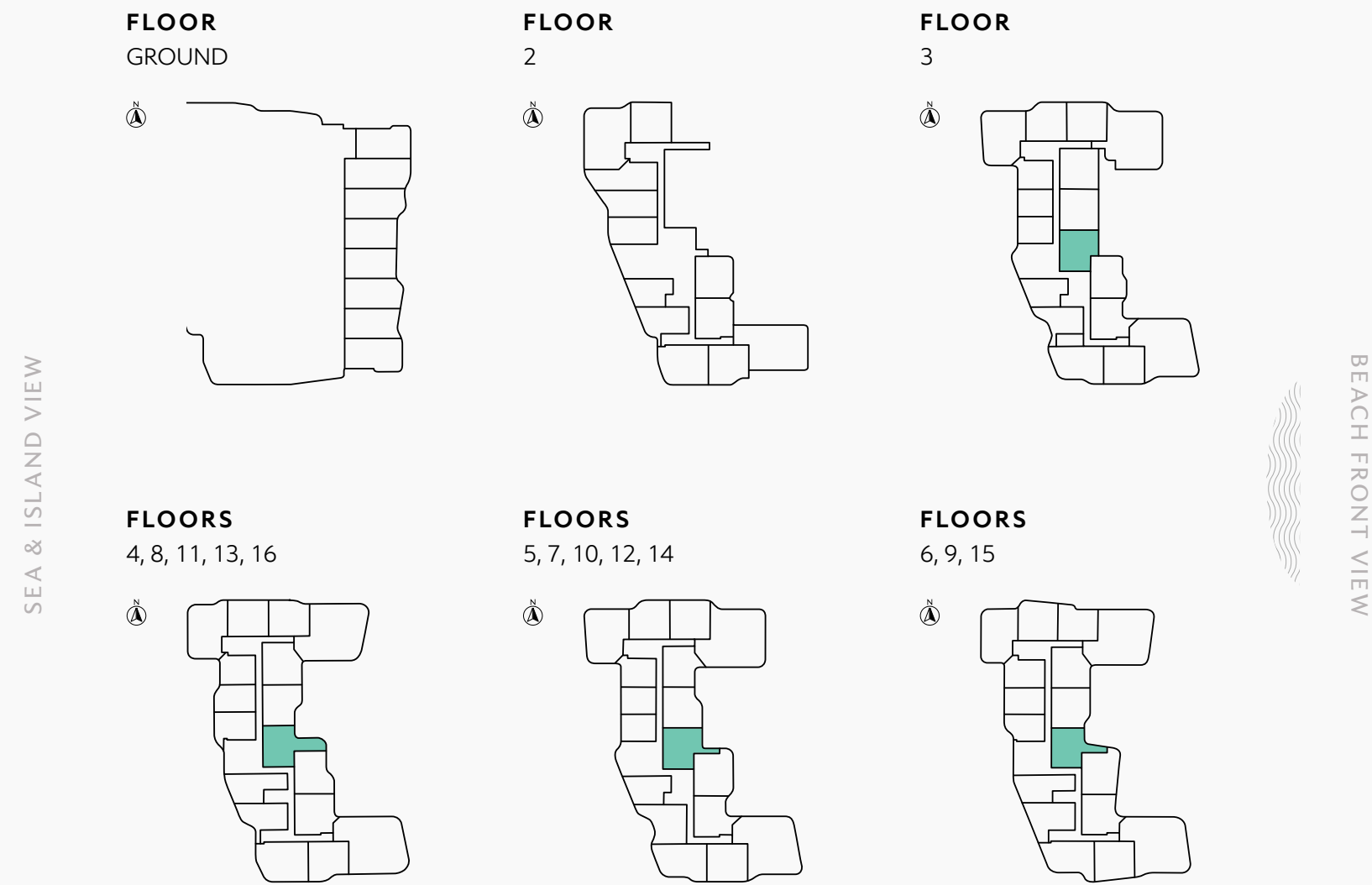
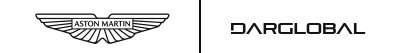

RESIDENCE	SQM	SQFT
Internal Area	68 - 75	736 - 810
Balcony Area	24 - 37	260 - 397
Total Built up Area	99 - 111	1,062 - 1,197

Disclaimer: All pictures, plans, layouts, information, data and details included in this brochure are indicative only and may change at any time up to the final 'as built' status in accordance with final designs of the project, regulatory approvals and planning permissions. All accessories and interior finishes such as wallpaper, chandeliers, furniture, electronics, white goods, curtains, hard and soft landscaping, pavements, features, gym, and other elements displayed in the brochure, or between the plot boundary, are not part of the unit and are shown for illustrative purposes only.



2 BEDROOMS TYPE D

The Astera
INTERIORS BY ASTON MARTIN

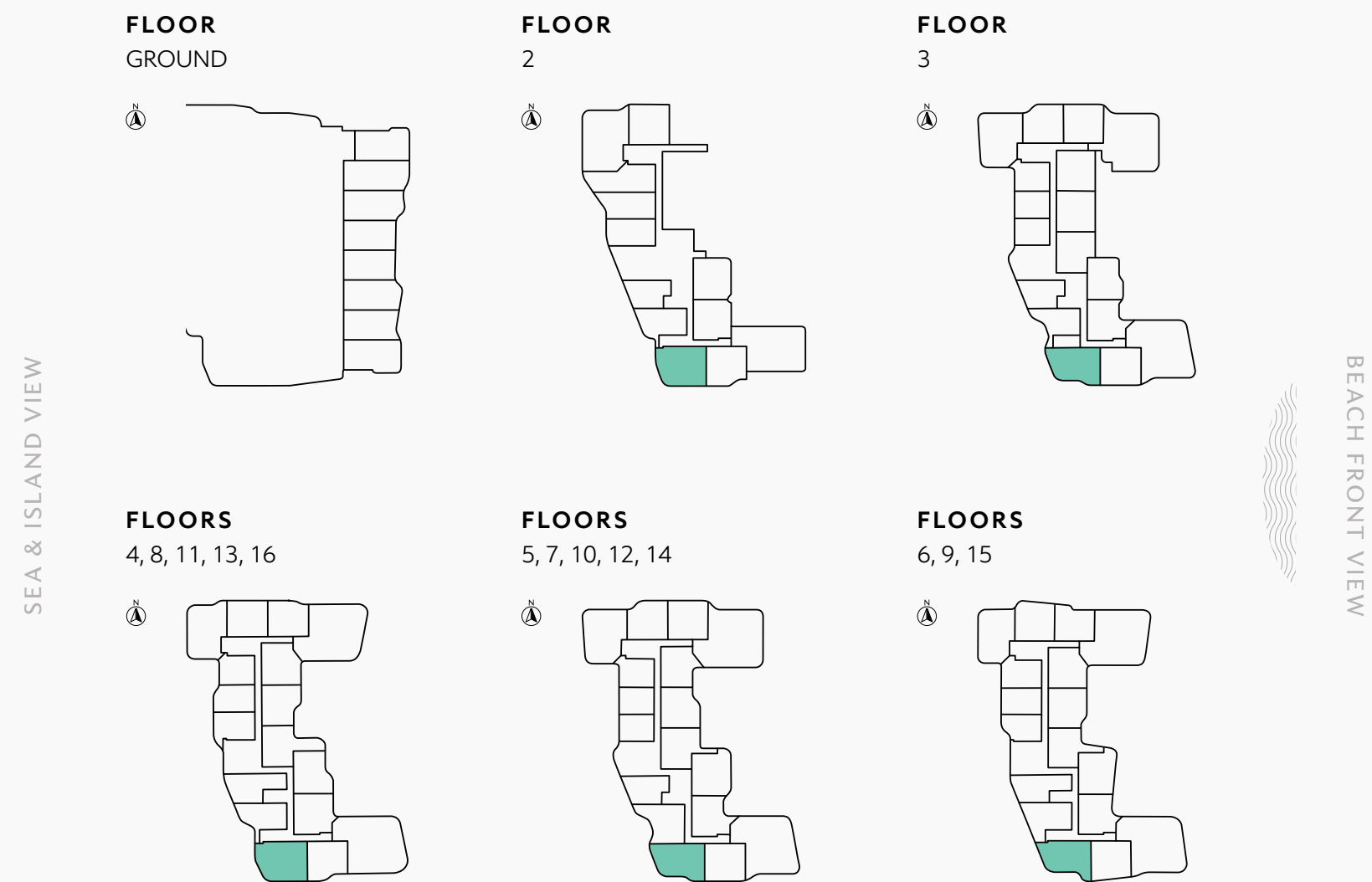
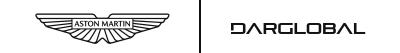

RESIDENCE	SQM	SQFT
Internal Area	73	787
Balcony Area	42 - 56	459 - 607
Total Built up Area	116 - 129	1,246 - 1,394

Disclaimer: All pictures, plans, layouts, information, data and details included in this brochure are indicative only and may change at any time up to the final 'as built' status in accordance with final designs of the project, regulatory approvals and planning permissions. All accessories and interior finishes such as wallpaper, chandeliers, furniture, electronics, white goods, curtains, hard and soft landscaping, pavements, features, gym, and other elements displayed in the brochure, or between the plot boundary, are not part of the unit and are shown for illustrative purposes only.

2 BEDROOMS TYPE E

The Astera
INTERIORS BY ASTON MARTIN

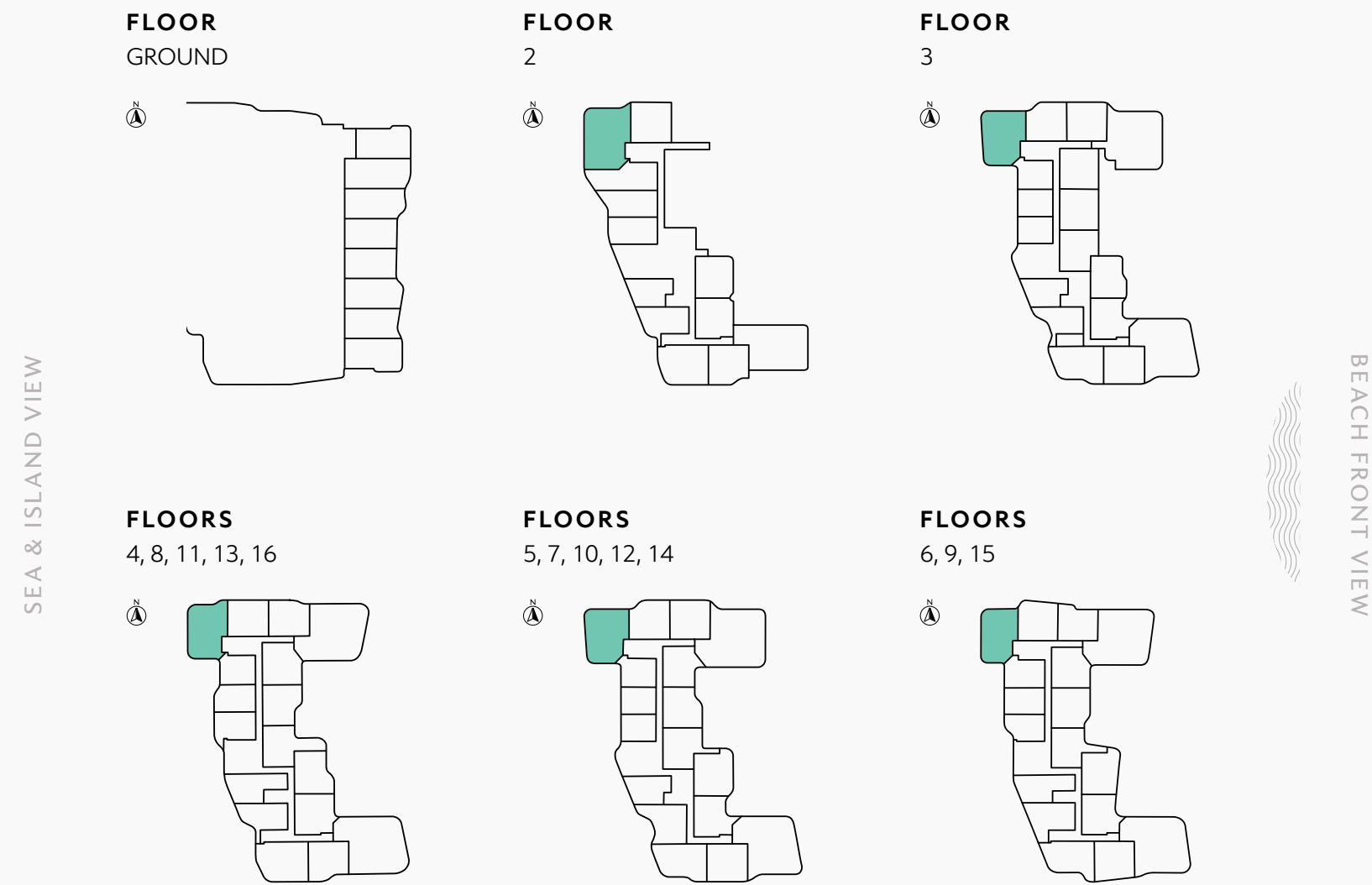
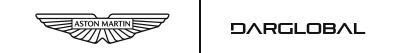

RESIDENCE	SQM	SQFT
Internal Area	76	820
Balcony Area	50 - 61	539 - 659
Total Built up Area	126 - 182	1,359 - 1,479



Disclaimer: All pictures, plans, layouts, information, data and details included in this brochure are indicative only and may change at any time up to the final 'as built' status in accordance with final designs of the project, regulatory approvals and planning permissions. All accessories and interior finishes such as wallpaper, chandeliers, furniture, electronics, white goods, curtains, hard and soft landscaping, pavements, features, gym, and other elements displayed in the brochure, or between the plot boundary, are not part of the unit and are shown for illustrative purposes only.

3 BEDROOMS TYPE A

The Astera
INTERIORS BY ASTON MARTIN

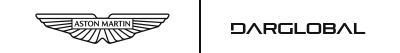

SEA & ISLAND VIEW

BEACH FRONT VIEW

FLOOR
GROUND

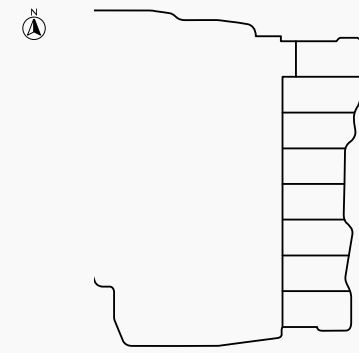

FLOOR
2

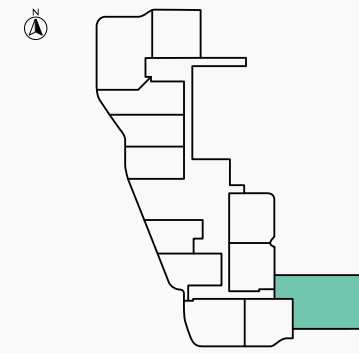

FLOOR
3

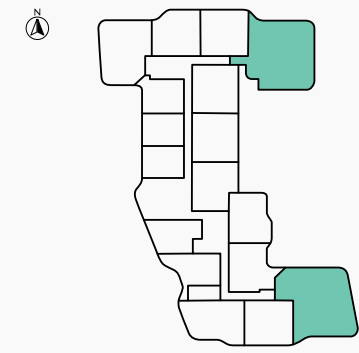

FLOORS
4, 8, 11, 13, 16

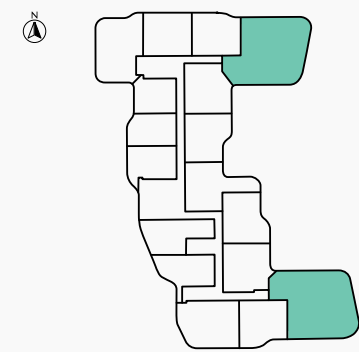

FLOORS
5, 7, 10, 12, 14

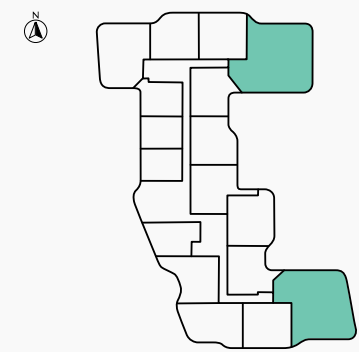

FLOORS
6, 9, 15

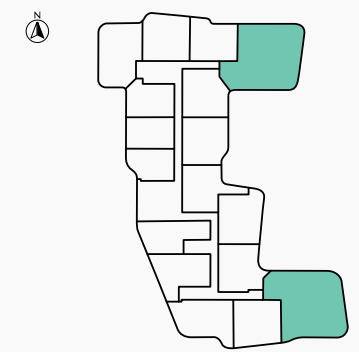

RESIDENCE	SQM	SQFT
Internal Area	136-140	1,466 - 1,508
Balcony Area	89 - 117	961 - 1,264
Total Built up Area	227 - 254	2,443 - 2,730

Disclaimer: All pictures, plans, layouts, information, data and details included in this brochure are indicative only and may change at any time up to the final 'as built' status in accordance with final designs of the project, regulatory approvals and planning permissions. All accessories and interior finishes such as wallpaper, chandeliers, furniture, electronics, white goods, curtains, hard and soft landscaping, pavements, features, gym, and other elements displayed in the brochure, or between the plot boundary, are not part of the unit and are shown for illustrative purposes only.





BUY | SELL | RENT | PROPERTY MANAGEMENT SERVICES

GET IN TOUCH WITH US

 **+971 56 818 8610**

 **info@homes4life.ae**

 **Head Office:**
Office 25 | Oasis Center | Sheikh Zayed Road | Dubai | +971 4 338 7300

Branch Office:
Retail 1 | Safi Apartments | Town Square Dubai | Dubai | +971 4 398 1528